

Main applications

Food & beverage

Characteristics

- Materials in contact with fluids: 316L-SS.
- Mechanically polished surfaces.
- Available in single and multiple (3, 5, 8) cartridges version.
- Suitable for cod.7 cartridges, length from 10" to 40".
- Compliant with 2014/68/UE PED Directive.
- Compliant with 2014/34/UE ATEX Directive.
- Compliant with 1935/2004/UE Directive.
- Suitable for not dangerous gases Gr.2.



CHARACTERISTICS	
Base / Bowl	316L-SS
V-clamp	304-SS
Internals	316L-SS
Internal surface finishing	Mechanical polishing
External surface finishing	Mechanical polishing
Design pressure	N.A.
Design temperature	N.A.
ATEX classification	II 2 GD IIC zone 1 & 21

Dimensions

Model	Type	Cartridge qty	Dimensions [mm]								
			A	B	C _{10"}	C _{20"}	C _{30"}	C _{40"}	D	E	In/out
GVCP01	1	1	88.9	43	315	565	815	1065	300÷1050	130	2"
GVCP03	2	3	219.1	97	351	601	851	1101	300÷1050	400	3"
GVCP05	2	5	219.1	106	345	595	845	1095	300÷1050	400	4"
GVCP08	2	8	273	120	349	599	849	1099	300÷1050	440	4"

Dimensions valid for in/out connection type TC ASME BPE.

Manufacturing tolerances: contact Asco Filtri.

For different connections, contact Asco Filtri.

Bowl with lifting handles only for 3, 5, 8 cartridges, from 20" to 40".

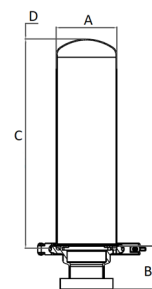

Type 1

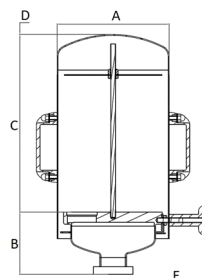

Type 2

Contact us for any further information.